

Maintenance No. 48

To ensure continuous trouble-free functioning, it is recommended that the winch be maintained as follows:

1. Routine maintenance at frequent intervals during constant use.
2. Full service annually.

Routine Maintenance.

A Using a small penknife or screwdriver remove top circlip (1) from spindle (22).

B Lift off drum and top cap assembly complete.

C Separate drum (11) and top cap assembly (5).

D Check that top cap mechanism and pawls (28) are functioning freely; with top cap mechanism inverted and push-button (3) depressed, the pawls will be normally in the open position.

E Grip the spring pillar posts on closing ring (8) and rotate in an anti-clockwise direction. This will close the pawls (28) and raise the push button (3). Both pawls (28) should now be in the fully closed position with the push button (3) locked in the raised position.

F Depress the push button (3) and the closing rings should rotate sharply in a clockwise direction, allowing both pawls to open fully. Should the rotation be sluggish or the pawls not fully open, the top cap must be stripped and cleaned prior to lubrication. See full annual service instructions.

G If the top cap mechanism functions correctly, clean off all salt deposits and dirt then oil lightly.

H Clean off all grease and salt deposits from drum bore (11), centre stem bearings (16) and ratchet gears (32, 34, 37, 38).

I Check free rotation of spindle (22) in centre stem (18). Check free operation of ratchet gears (32, 34, 37, 38).

J If satisfactory, proceed with routine maintenance. If not, continue with **Full Service Procedure**.

K Lightly grease bore of drum (11), centre stem bearings (16) and ratchet gears (32, 34, 37, 38).

L Apply oil to centre spindle (22) and ratchet gear pawls through interface of ratchet gears.

M Reassemble drum (11) to centre stem.

N Replace top cap assembly, ensuring that pawls are in the closed position i.e. push button

(3) is raised. Align drive slots in top cap (5) with drive pin (23) in spindle. Push top cap into recess in drum (11).

O Replace circlip (1) by entering one end into groove in spindle (22) and winding circlip into place.

P Check free rotation of drum (11) and, using handle, centre spindle (22).

Full Annual Service

Note.

To service completely the winch must be removed from the deck by removal of the 6 x 5/16" UNC C'sk screws securing the centre stem.

Q Remove drum and top cap as points **A-C**.

R Remove centre stem from deck.

S Slide out cross-mounted drive pin (23) and remove clutch plate (12).

T Remove two plungers (14) and two springs (15), taking care not to lose these.

U Remove bearings (16) and drum support washer (19).

V Support the centre stem assembly (18) by the base on a firm structure (work bench etc.).

W Ensure the lower exits of bearing spindles (29, 36) are not covered. Using a flat-ended drift, tap out bearing spindles **DOWNWARDS**.

X Before fully removing spindles (29, 36) drive out about 1mm and check that knurled end is projecting before driving through. Knurled end of spindles **MUST NOT** pass through gears. Drive out spindles to release gear assemblies.

Y Remove ratchet gear assemblies and washers.

Z Separate ratchet gears (37, 38), remove two pawls (33) and two pawl springs (7). Remove washers (30,35). Remove two bearings (31).

A1 Separate ratchet gears (32, 34), remove two pawls (33) and two pawl springs (7). Remove washers (30,35). Remove bearing (31).

B1 Prise out two collets (13) from centre stem (18).

C1 Withdraw centre spindle (22) from centre stem (18). Remove bearing (20) and washer (21).

D1 Remove C'sk screw (27) securing lower ratchet assembly. Withdraw ratchet gear (25), spacer (24) and spindle end cap (26) or coupling (in the case of linked winches).

E1 Remove two pawls (28), and two pawl springs (7) from spindle.

F1 Carefully wash drum, centre stem, spindle, roller bearings, gears, spacers, washers, pawls and pawl springs.

G1 Lightly grease drum bore, roller bearings, centre spindle and centre stem bearing area.

H1 Reassemble two pawls (28) and two pawl springs (7) to spindle (22). Oil lightly.

I1 Reassemble spacer (24), ratchet gear (25) and spindle end cap (26) to spindle (22). Secure with screw (27) and firmly tighten.

NOTE: correct location of annular groove (see sketch).

J1 Place washer (21) and bearing (20) onto spindle (22). Slide into centre stem (18). Secure with two collets (13).

K1 Replace two pawls (33) and two pawl springs (7) in pawl gears (32, 38). Reassemble ratchet gear (34) to (32). Put washer (35) in place. Replace bearing (31) and washer (30).

L1 Reassemble ratchet gear (37) to (38). Put washer (35) in place. Replace bearings (31) and washer (30).

M1 Support centre stem on the gear aperture shoulder. Insert ratchet gear assemblies and engage ratchet spindle (22). Ensure line-up.

N1 Insert gear spindles (29, 36) and engage with ratchet gear assemblies.

O1 With drift, tap spindles into place.

P1 Replace drum support washer (19), roller bearings (16).

Q1 Replace two springs (15) and two plungers (12). Replace clutch plate (12).

R1 Insert drive pin (23).

S1 Replace drum (11).

Top Cap Maintenance

T1 To dismantle top cap assembly completely, remove large circlip (10), disengage two springs (9), close pawls and withdraw closing ring (8). Remove plunger (4) and compression spring (6). Remove two pawls (28) and two pawl springs (7).

U1 Carefully clean all components.

V1 Reassemble two pawls (28) and two pawl springs (7). Lightly oil.

W1 Replace plunger (4) and compression spring (6).

X1 Engage closing ring (8) with compression spring and plunger and holding pawls closed, insert closing ring into recess.

Y1 Ensure closing ring (8) seats correctly at base of recess. Re-insert circlip (10) and engage

Lewmar

Three speed winches

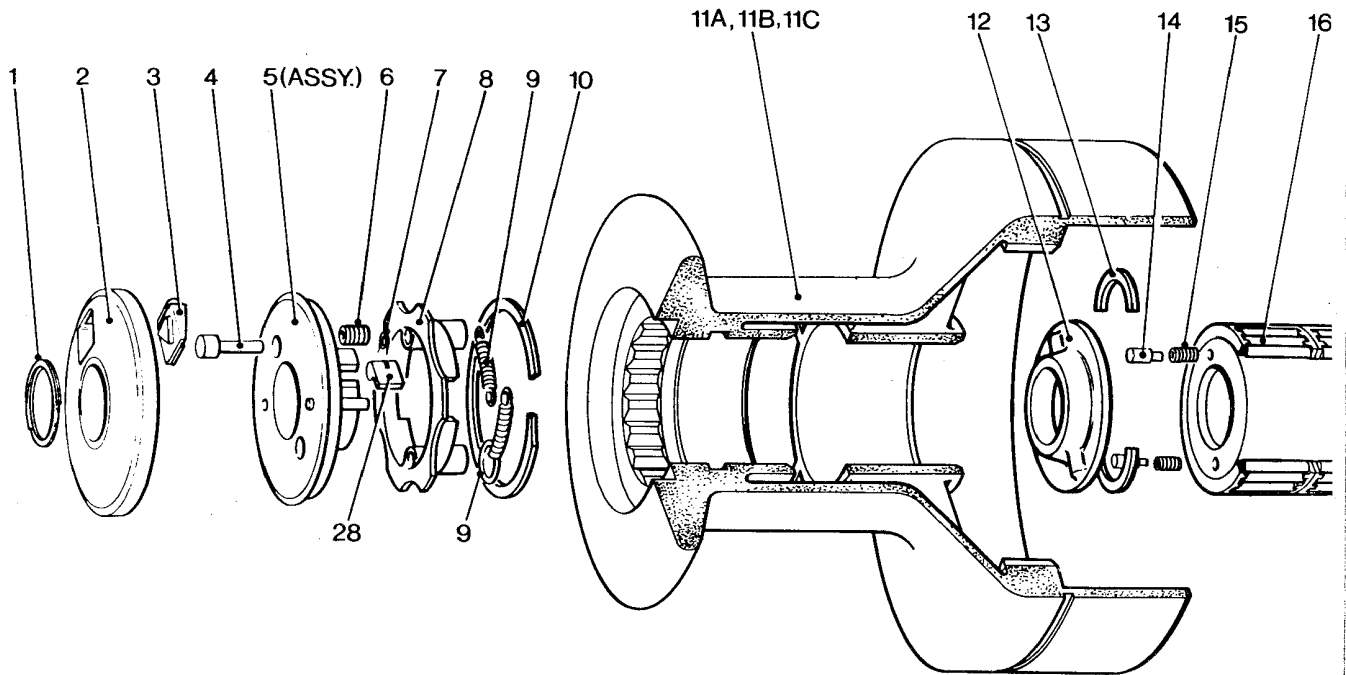

with groove provided.

Z1 Engage two springs (9) with pillars provided on closing ring (8).

A2 Check top cap mechanism for correct operation, as prescribed in point (F). Oil lightly.

B2 Reassemble and check winch as points (N-P).

C2 If winch fails to perform correctly, re-check servicing technique or contact your nearest Lewmar service point.

Spare Parts Kits

Model 48

Cat No 19748400

Contents

4 x Pawl Pt No 1260/8

8 x Spring Pt No 1260/7

4 x Pawl Pt No 1264/8

2 x Washer Pt No 1300/22

2 x Washer Pt No 1264/7

2 x Plunger Pt No 1300/24

2 x Spring 1300/20

1 x Plunger Pt No 15044111

1 x Spring Pt No 15044112

1 x Washer Pt No 15025107

1 x Circlip Pt No B2083

1 x Circlip Pt No B2075

1 x Pin Pt No 15044119

2 x Spring Pt No 15044113

Model 48

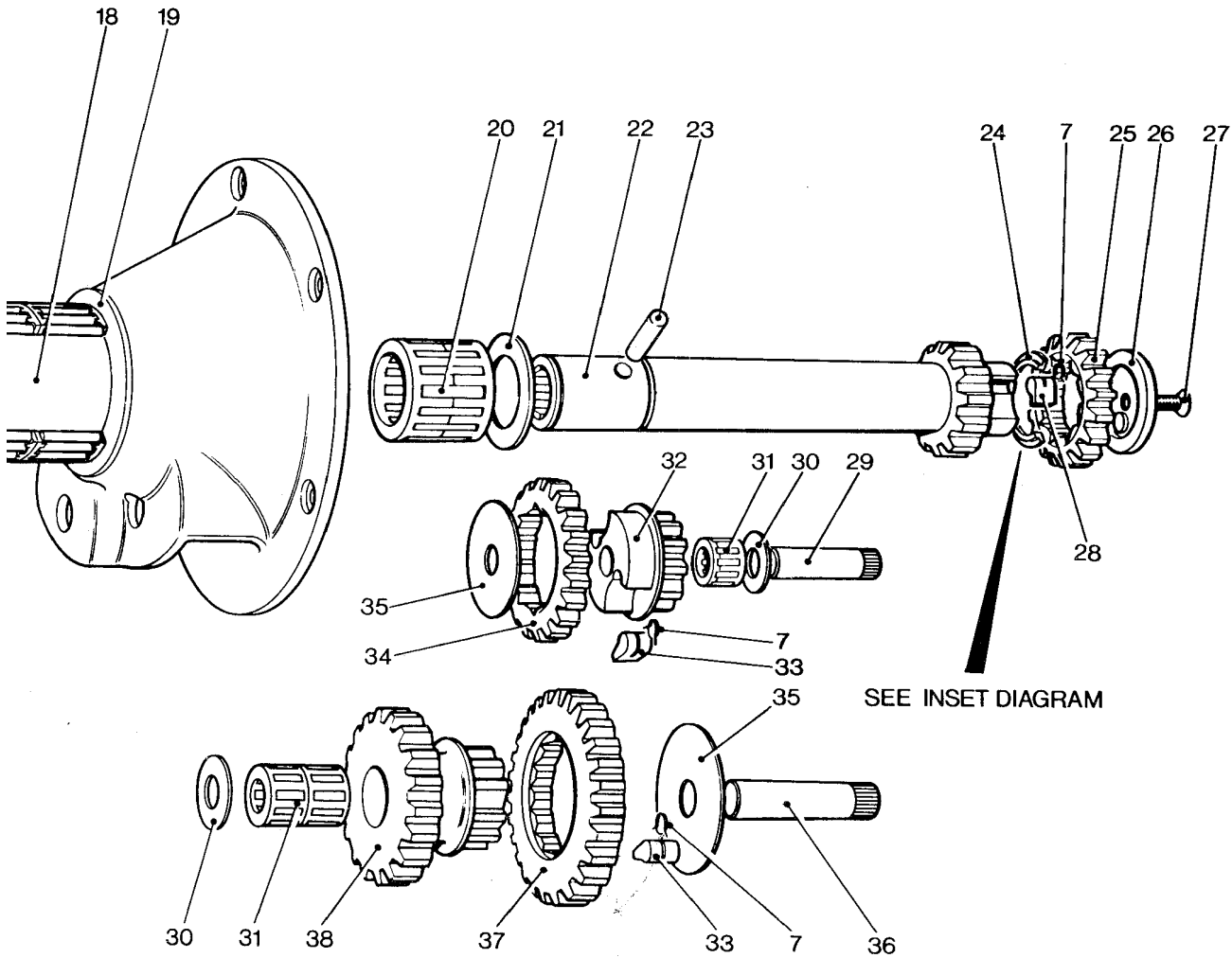

SEE INSET DIAGRAM

Parts list

Item Number	Part Number	Description	No. Off
1	B2075	Circlip, Spirolox	1
2	15048106	Top Cap Cover	1
3	15044114	Push Button	1
4	15044111	Plunger	1
5	15044104	Top Cap Assembly	1
6	15044112	Spring	1
7	1260/7	Pawl Spring	8
8	15044106	Closing Ring	1
9	15044113	Spring	2
10	B2083	Circlip	1
11A	15048102	Drum, Bronze	1
11B	15048202	Drum, Alloy	1
11C	15048302	Drum, Stainless Steel	1
12	15044105	Clutch Plate	1
13	15044118	Collet	2
14	1300/24	Plunger	2
15	1300/20	Spring	2
16	1301/SA3	Cage Assembly	3
18	15048101	Centre Stem	1
19	15044116	Washer	1
20	1264/SA2	Cage Assembly	1
21	1300/21	Washer	1
22	15048103	Spindle	1
23	15044119	Drive Pin	1
24	15025107	Spacer	1
25	15048104	Ratchet Gear	1
26	15016107	Spindle End Cap	1
27	B0515	Countersunk Screw 1/4" U.N.C. x 1/2" long	1
28	1260/8	Pawl	4
29	1300/10	Spindle	1
30	1300/22	Washer	2
31	1300/SA2	Cage Assembly	3
32	1300/8	Pawl Gear	1
33	1264/8	Pawl	4
34	1300/7	Ratchet Gear	1
35	1264/7	Washer	2
36	1300/9	Spindle	1
37	1300/5	Ratchet Gear	1
38	1300/6	Pawl Gear	1